

# RAPTOR GUARD™ POLE TOP CAP PERCHING EXCLUDERS

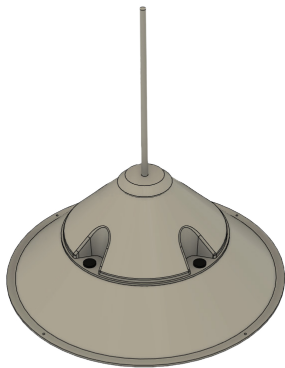

**POLE TOP CAPS ISOLATE DANGEROUS ENERGIZED AREAS  
AND REDUCE BIRDS OF PREY FROM USING STRUCTURES  
AS HUNTING PERCHES.**



BLUNT-TIPPED SPIKES DETERS PERCHING, AS PROVEN BY LIVE FLIGHT CAGE RAPTOR TESTS CONDUCTED IN COLLABORATION WITH THE ROCKY MOUNTAIN RAPTOR PROGRAM

ENGINEERED TO MAINTAIN STRUCTURAL INTEGRITY UNDER EXTREME ENVIRONMENTAL CONDITIONS FOR DECADES

DURABILITY AND EFFECTIVENESS HAS BEEN HIGHLIGHTED DURING PILOT PROGRAMS BY THE WASHINGTON STATE FISH AND WILDLIFE AND THE BUREAU OF LAND MANAGEMENT

CAN BE INSTALLED ON WOOD, STEEL OR COMPOSITE



# RAPTOR GUARD™ POLE TOP CAP PERCHING EXCLUDERS



RAPTOR GUARD™  
POLE TOP CAP  
RGPT-26

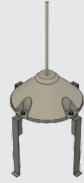

RAPTOR GUARD™ POLE TOP CAP KIT  
FOR BANDING TO POLES  
RGPT-K

SKU	DIAMETER	RECOMMENDED POLE TOP DIAMETER
RGPT-8	8"	7 - 9"
RGPT-10	10"	9 - 11"
RGPT-12	12"	11 - 13"
RGPT-14 *	14"	13 - 15"
RGPT-16 *	16"	15 - 17"
RGPT-18 *	18"	17 - 19"
RGPT-20 *	20"	19 - 21"
RGPT-22 *	22"	21 - 23"
RGPT-24 *	24"	23 - 25"
RGPT-26 *	26"	25 - 27"
RGPT-28 *	28"	27 - 29"
RGPT-30 *	30"	29 - 31"
RGPT-32 *	32"	31 - 33"
RGPT-34 *	34"	33 - 35"
RGPT-36 *	36"	35 - 37"
RGPT-38 *	38"	37 - 39"
RGPT-40 *	40"	39 - 41"
RGPT-42 *	42"	41 - 43"
RGPT-K	ADAPTER KIT FOR BANDING TO NON-WOOD POLE	

\* INCLUDES ADAPTER KIT FOR BANDING TO NON-WOOD POLES

TESTS	RESULTS
ASTM D-638 TENSILE STRENGTH	70,000 PSI
ASTM D-695 COMPRESSIVE STRENGTH	20,000 PSI
ASTM D-149 DIELECTRIC STRENGTH	50KV/IN

